

# HENDERSONVILLE HIGH SCHOOL STILLWELL BUILDING ROOF REPLACEMENT

MARK LUSK ARCHITECTURE PLLC  
120 WEDGEWOOD DR  
SWANNANOVA, NC 28778  
828.808.9757  
MLARCHITECTURE@CHARTER.NET

## HENDERSONVILLE COUNTY PUBLIC SCHOOLS

### CONTACTS

#### Owner Representative

MARTIN BALLARD  
HENDERSONVILLE COUNTY PUBLIC SCHOOLS  
246 EDUCATION DRIVE  
FLAT ROCK, NC 28731

BRIAN CANTRELL  
HENDERSONVILLE COUNTY PUBLIC SCHOOLS  
246 EDUCATION DRIVE  
FLAT ROCK, NC 28731

#### Architect

MARK LUSK ARCHITECTURE PLLC  
128 WOODBURN DRIVE  
SWANNANOVA, NC 28778  
828.808.9757

### LIST OF DRAWINGS

T101	COVER SHEET
ARCHITECTURAL	
A201	MAIN BUILDING ROOF PLAN
A202	AUDITORIUM ROOF PLAN
A301	DETAILS

#### 2012 NORTH CAROLINA ENERGY CODE

- PER NC HOUSE BILL 201: BUILDING RE-UTILIZATION FOR ECONOMIC DEVELOPMENT ACT: CONSTRUCTED BEFORE 2012, THIS BUILDING QUALIFIES FOR AN ALTERNATE ENERGY CODE COMPLIANCE PATH ALLOWING THE USE OF THE 2009 NC ENERGY CONSERVATION CODE. R-VALUE MIN. SHALL BE R-15.
- 502.2.1 EXCEPTION- R:VALUE OF TAPERED INSULATION SHALL BE 1" ABOVE MINIMUM THICKNESS
- 101.4.3 NCDOI CODE INTERPRETATION 10/9/15: EXISTING EXPOSED INSULATION REMAINS- NO INSULATION UPGRADE REQUIRED.

#### NOTES:

- APPROXIMATE ROOF AREA: 23,164 SQUARE FEET
- REPLACE= REMOVE EXISTING AND PROVIDE AS SHOWN AND SPECIFIED

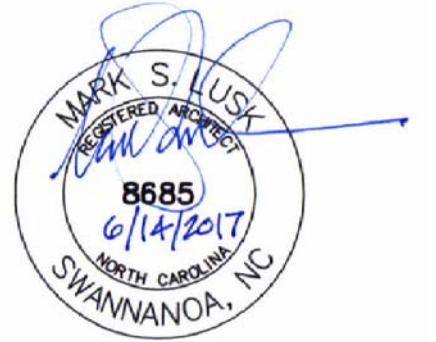
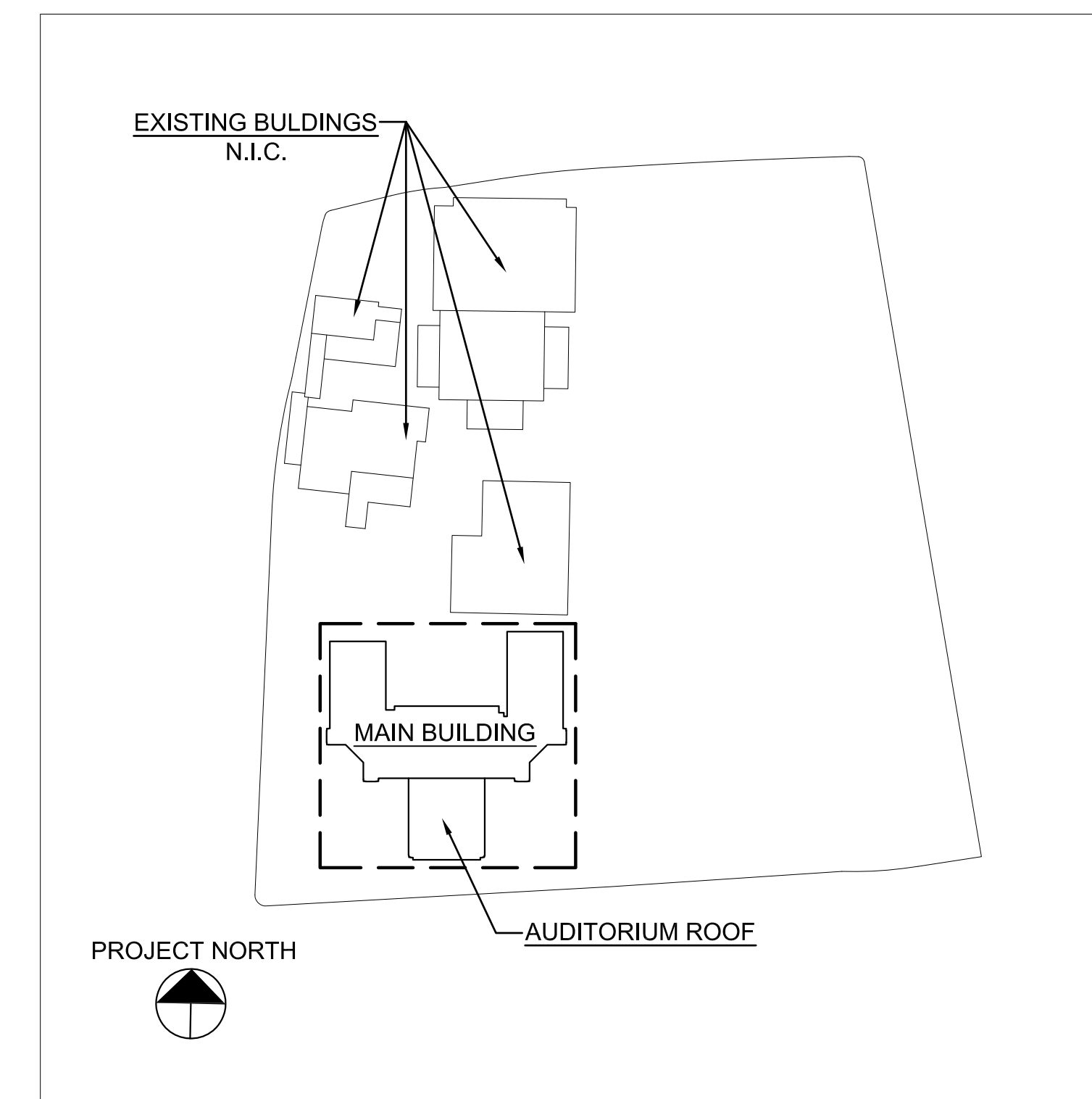

HENDERSONVILLE  
HIGH SCHOOL  
STILLWELL  
BUILDING ROOF  
REPLACEMENT

Project Number: 17007  
Checked:  
Drawn: A. Rognas  
Date: 6/14/17  
Revisions:

Cover Sheet

T101

© Copyright 2017. All Rights Reserved. Reproduction, copying or use of this drawing and designs shown hereon without written consent of Mark Lusk Architecture PLLC is prohibited and any infringement is subject to legal action.

MARK LUSK ARCHITECTURE PLLC  
120 WEDGEWOOD DR  
SWANNANOVA, NC 28778  
828.808.9757  
MLARCHITECTURE@CHARTER.NET

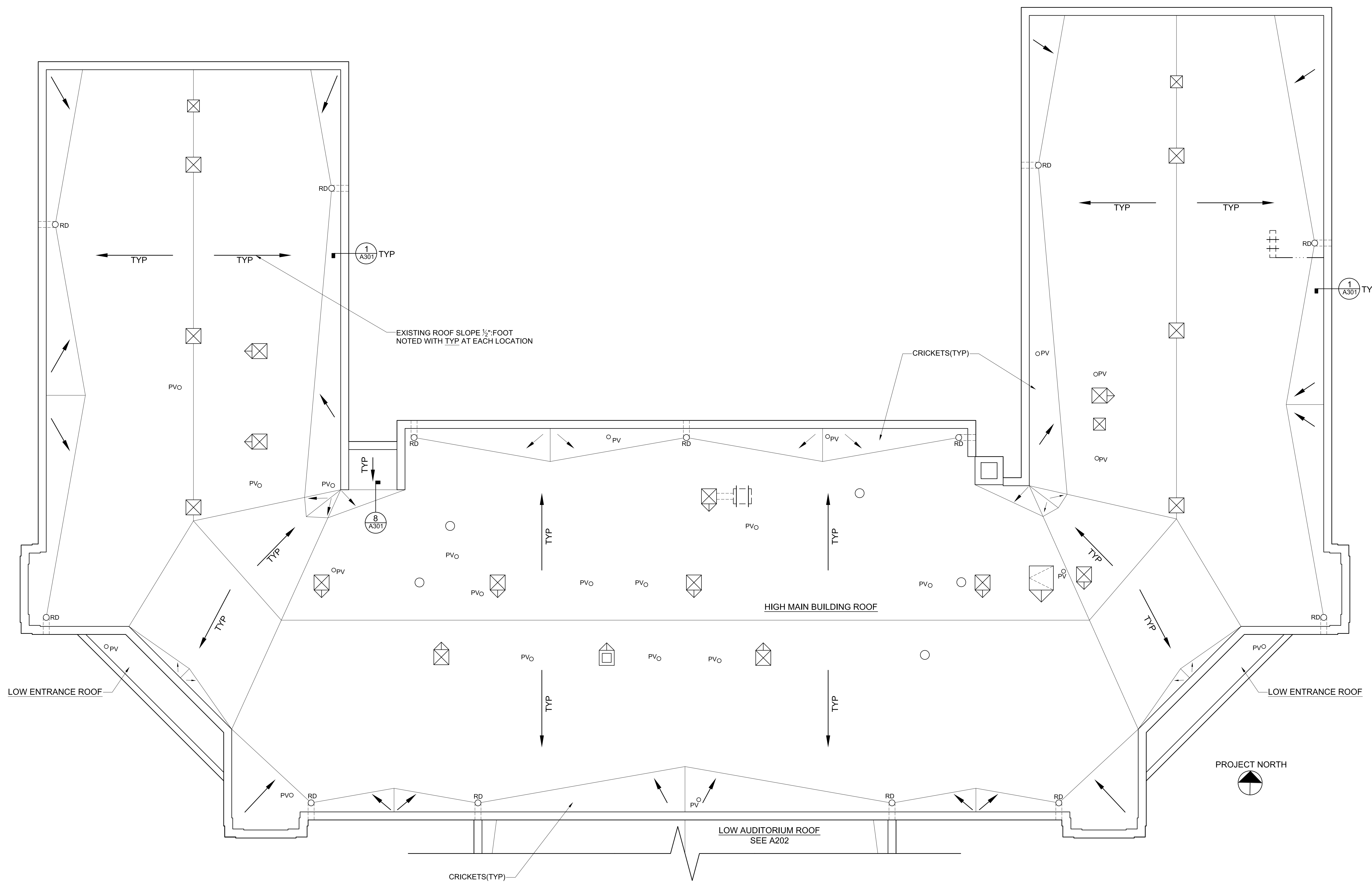

MAIN BUILDING ROOF PLAN  
SCALE: 1/8" = 1'-0"

**HENDERSONVILLE  
HIGH SCHOOL  
STILLWELL  
BUILDING ROOF  
REPLACEMENT**

Project Number: 17007  
Checked: \_\_\_\_\_  
Drawn: A. Rognas  
Date: 6/14/17  
Revisions: \_\_\_\_\_  
\_\_\_\_\_  
\_\_\_\_\_

**Main Building  
Roof Plan**

**ROOFING NOTES - A201, A202**

1. EXISTING ROOFING COMPONENTS:

MODIFIED BITUMEN MEMBRANE  
 1½" POLYISO INSULATION  
 BUILT-UP ROOFING  
 CONCRETE ROOF DECK

2. REMOVE EXISTING MODIFIED BITUMEN ROOFING SYSTEM AND COMPONENTS, POLYISO INSULATION, AND BUILT-UP ROOFING DOWN TO EXISTING CONCRETE ROOF DECK.

3. REPLACE EXISTING ROOF DRAINS.

4. PROVIDE FULLY ADHERED 60 MIL TPO MEMBRANE ROOFING SYSTEM OVER ATTACHED 2½" POLYISO INSULATION ON EXISTING CONCRETE ROOF DECK.

**GENERAL NOTES - A201, A202**

1. EXISTING WOOD NAILER SHALL REMAIN UNLESS DETERMINED TO BE DAMAGED BY OWNER. REMOVAL AND REPLACEMENT SHALL BE PERFORMED AT UNIT PRICE.

2. VERIFY DIMENSIONS, QUANTITIES, SIZES, AND OTHER EXISTING CONDITIONS PRIOR TO DEMOLITION WORK. DISCREPANCIES BETWEEN DOCUMENTS AND EXISTING CONDITIONS SHALL BE REPORTED TO THE ARCHITECT.

3. RAISE EXISTING VP'S AND MECHANICAL CURBS TO 8" ABOVE ROOFING. ELECTRICAL WORK, IF REQUIRED TO REMOVE VENTILATORS, SHALL BE PERFORMED BY LICENSED CONTRACTOR.

4. CRICKETS SHALL SLOPE AT ½" PER FOOT.

5. EXISTING ELECTRIC COMPONENTS, REFRIGERANT LINES, MECHANICAL UNITS, SHALL BE TEMPORARILY RELOCATED FOR FULL ROOFING INSTALLATION.

6. SITE ACCESS, STAGING AND SCHEDULE TO BE COORDINATED WITH PRINCIPAL.

7. PROVIDE 18-8 OR 304 STAINLESS STEEL FASTENERS WHERE IN CONTACT WITH PRESSURE TREATED WOOD.

8. CONTRACTOR SHALL PERFORM ALL WORK IN COMPLIANCE WITH THE AHJ. COSTS FOR PERMITS SHALL BE INCLUDED IN WORK. PROVIDE INSPECTION DOCUMENTS TO THE OWNER.

**ROOF PLAN LEGEND - A201, A202**

- ⊗ MECHANICAL VENTILATOR ON CURBS, FLASH CURBS, PROVIDE CRICKET. SEE 4/A301
- ⊗ FLASH PLUMBING VENT. RAISE TO 8" ABOVE ROOFING. REFLASH EXISTING SCUPPER. SEE 5/A301.
- ⊗ RD REPLACE EXISTING ROOF DRAIN. REFLASH EXISTING OVERFLOW SCUPPER. (SLOPE SURROUNDING INSULATION.) SEE 6/A301, 1/A301.
- ⊗ REPLACE POURABLE SEALER POCKET AT CONDUITS
- ⊗ FLASH EXISTING ROOF HATCH. PROVIDE CRICKET. SEE 2/A301.
- ⊗ PROVIDE PROTECTIVE MEMBRANE SHEETS AT EXISTING WOOD SLEEPERS AT MECHANICAL UNITS
- ⊗ FLASH CURB UNDER EXISTING LARGE MECHANICAL UNIT. (RAISE UNIT FOR FLASHING)
- ⊗ ELECTRICAL CONDUIT ON WOOD BLOCKS. REPLACE WOOD BLOCKS.
- ⊗ FLASH EXISTING ROUND ROOF VENTILATOR. SEE DETAIL 7/A301
- ⊗ FLASH EXISTING BRICK CHIMNEY. SEE 3/A301

© Copyright 2017. All Rights Reserved. Reproduction, copying or use of this drawing and designs shown hereon without written consent of Mark Lusk Architecture PLLC is prohibited and any infringement is subject to legal action.

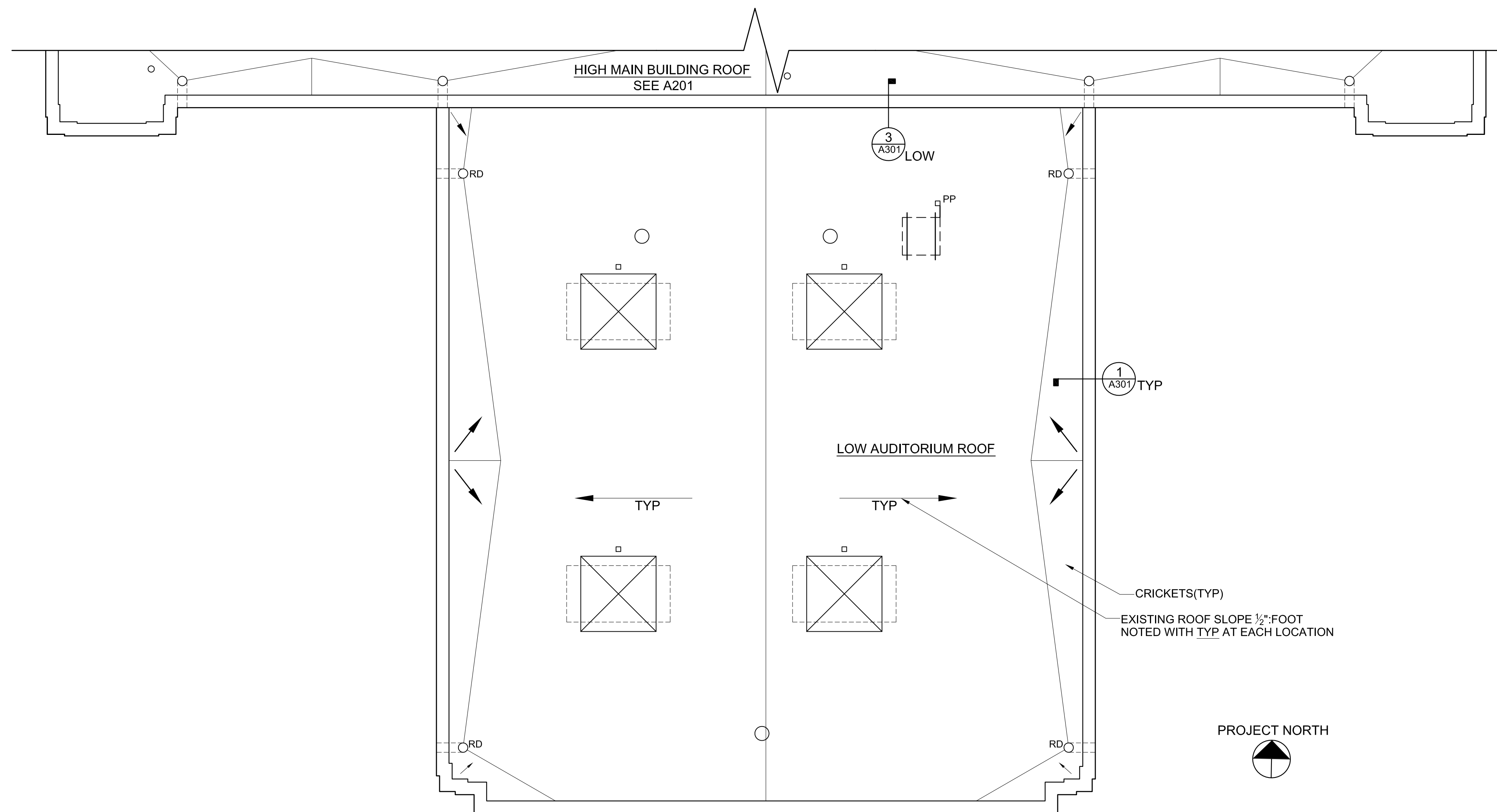

**AUDITORIUM ROOF PLAN**  
 SCALE: 3/8" = 1'-0"

MARK LUSK ARCHITECTURE PLLC  
 120 WEDGEWOOD DR  
 SWANNANOVA, NC 28778  
 828.808.9757  
 MLARCHITECTURE@CHARTER.NET

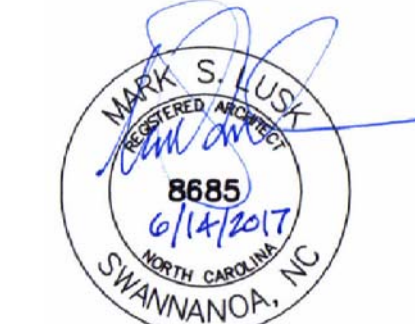

**HENDERSONVILLE  
 HIGH SCHOOL  
 STILLWELL  
 BUILDING ROOF  
 REPLACEMENT**

Project Number: 17007  
 Checked: \_\_\_\_\_  
 Drawn: A. Rognas  
 Date: 6/14/17  
 Revisions: \_\_\_\_\_

**Auditorium  
 Roof Plan**

**A202**

© Copyright 2017. All Rights Reserved. Reproduction, copying or use of this drawing and designs shown thereon without written consent of Mark Lusk Architecture PLLC is prohibited and any infringement is subject to legal action.

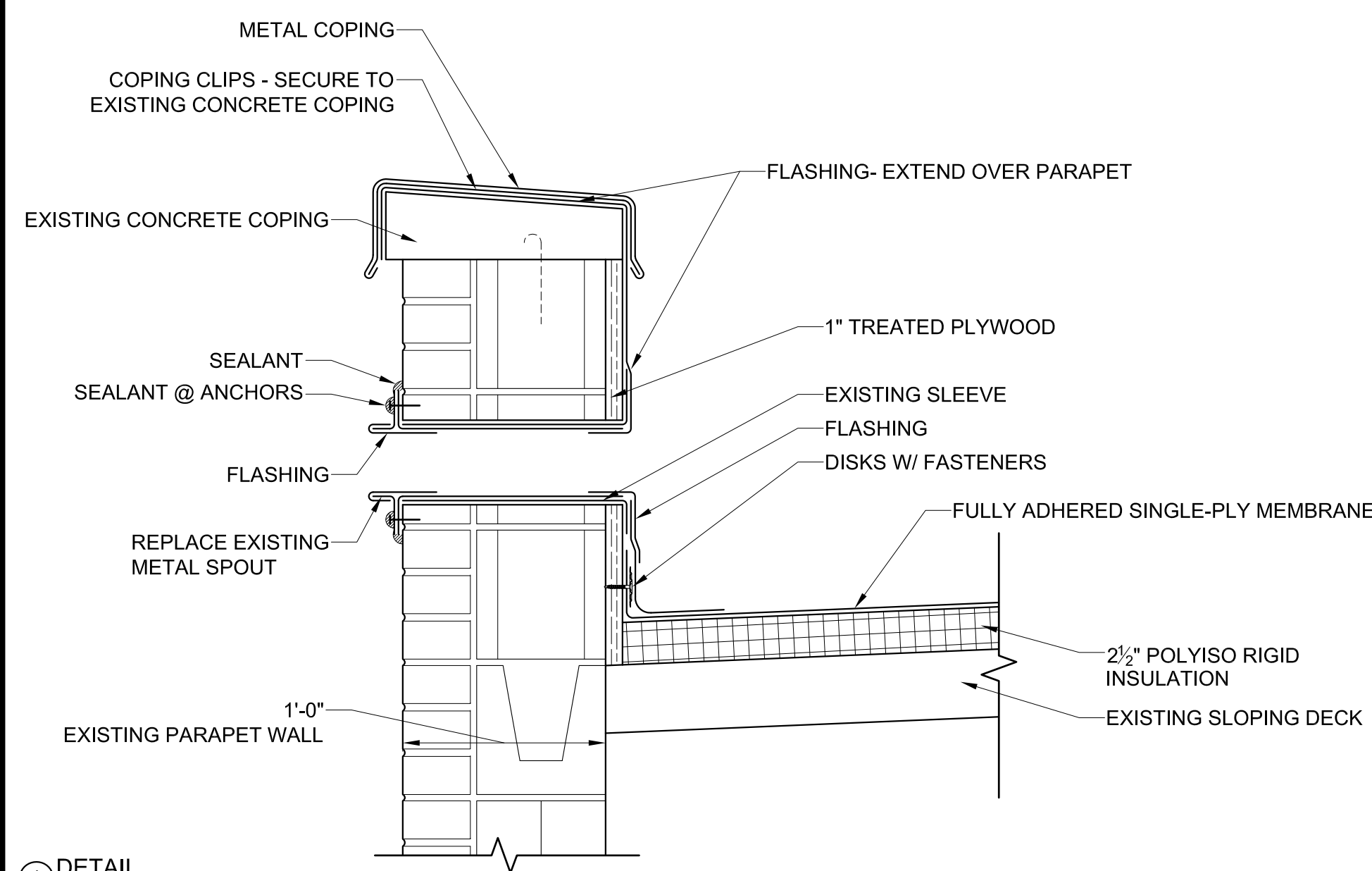

1 DETAIL  
SCALE: 1/2" = 1'-0"

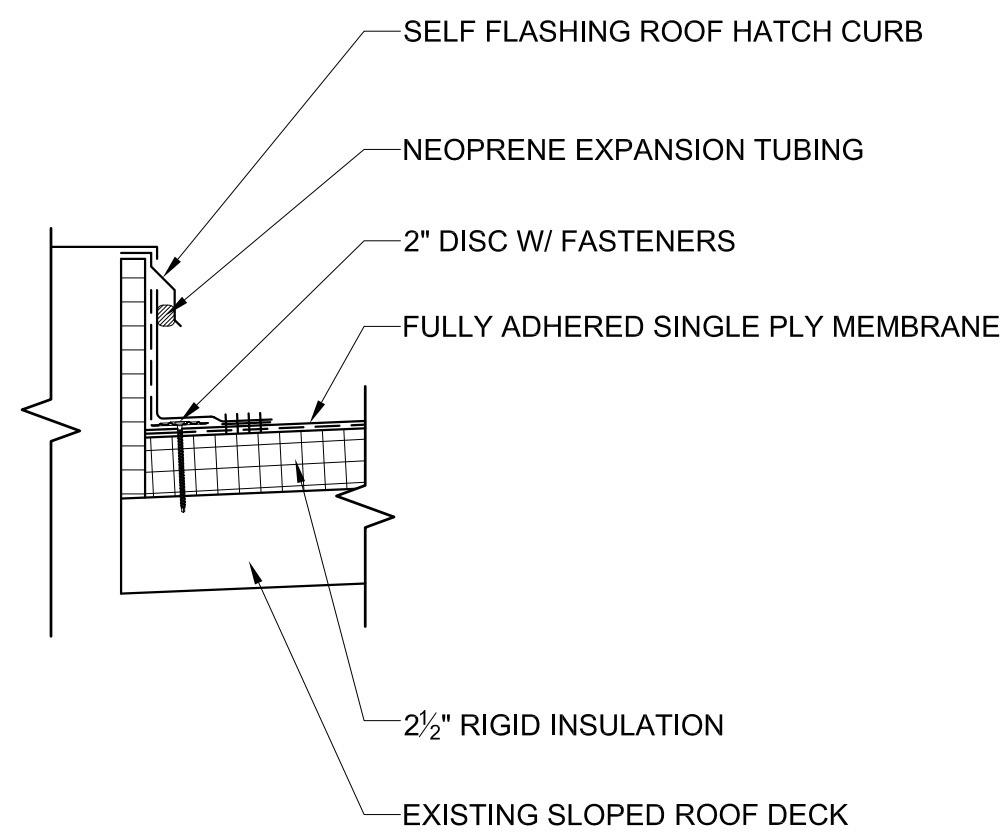

2 ROOF HATCH  
SCALE: 1/2" = 1'-0"

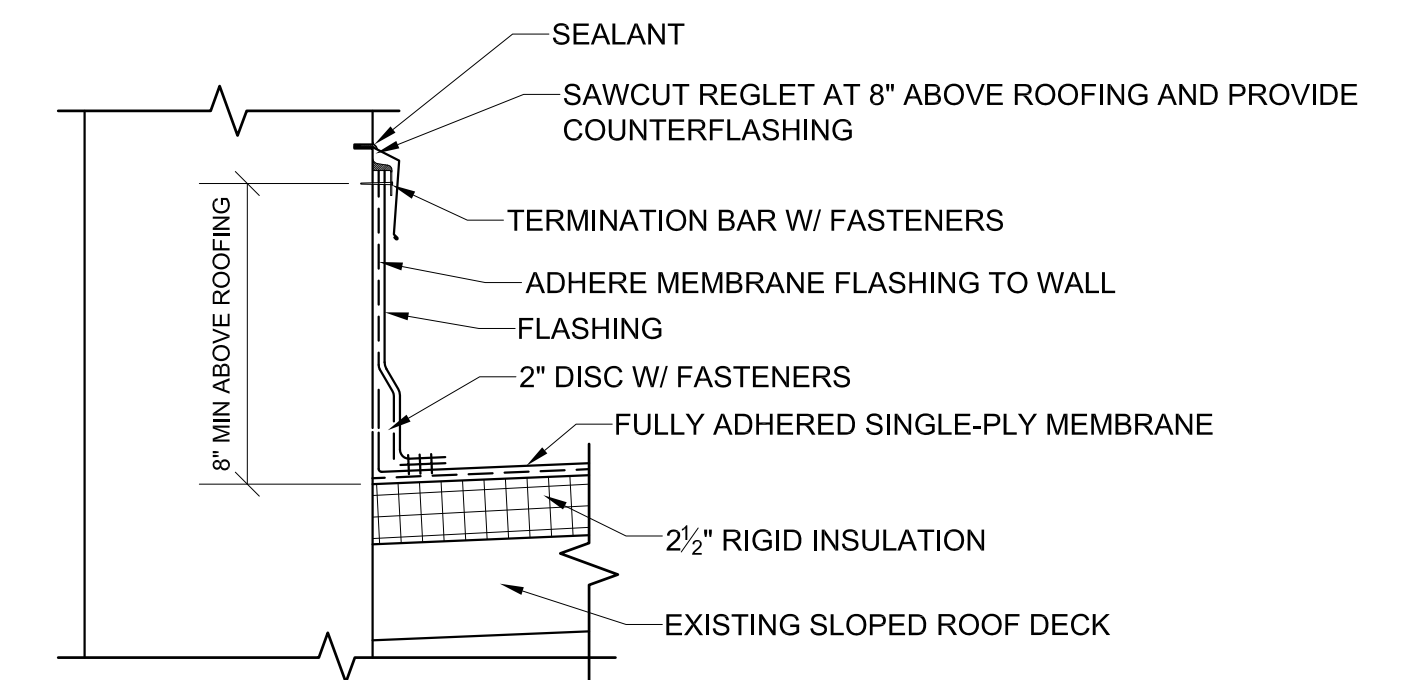

3 BASE OF WALL DETAIL  
SCALE: 1/2" = 1'-0"

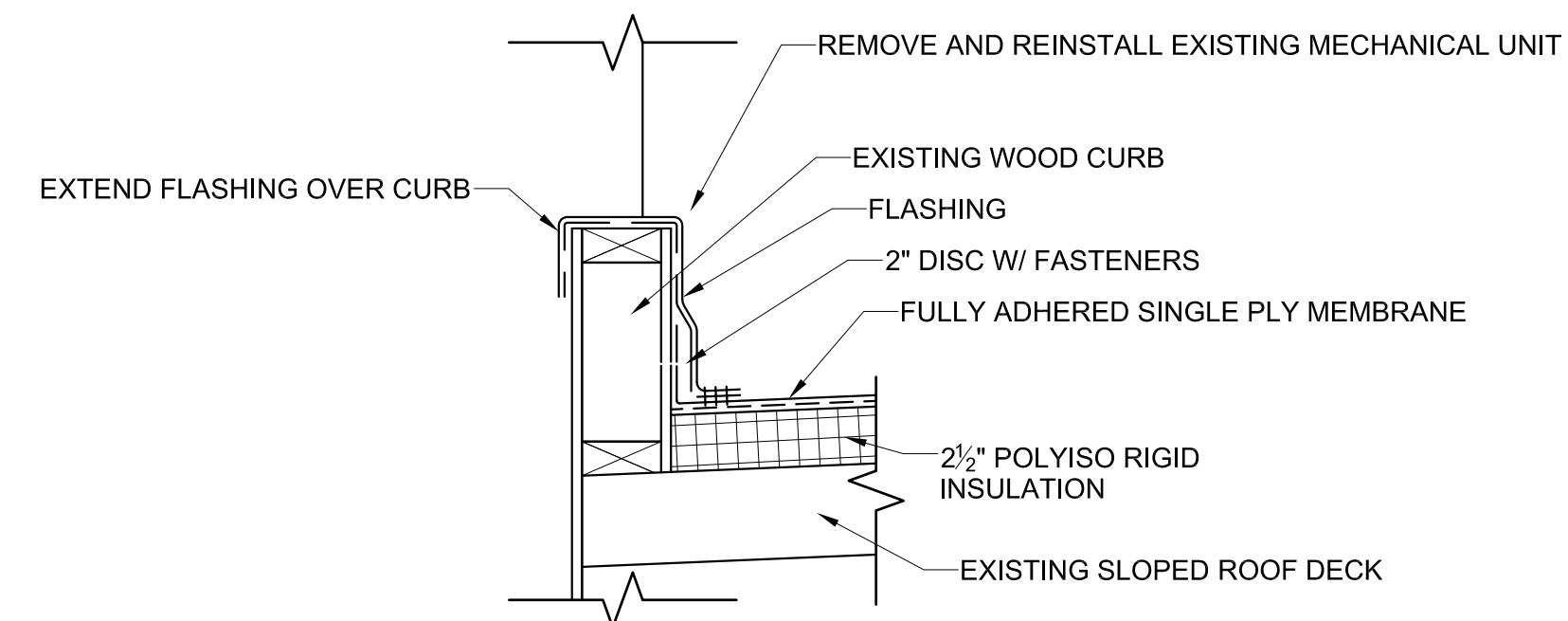

4 MECHANICAL CURB DETAIL  
SCALE: 1/2" = 1'-0"

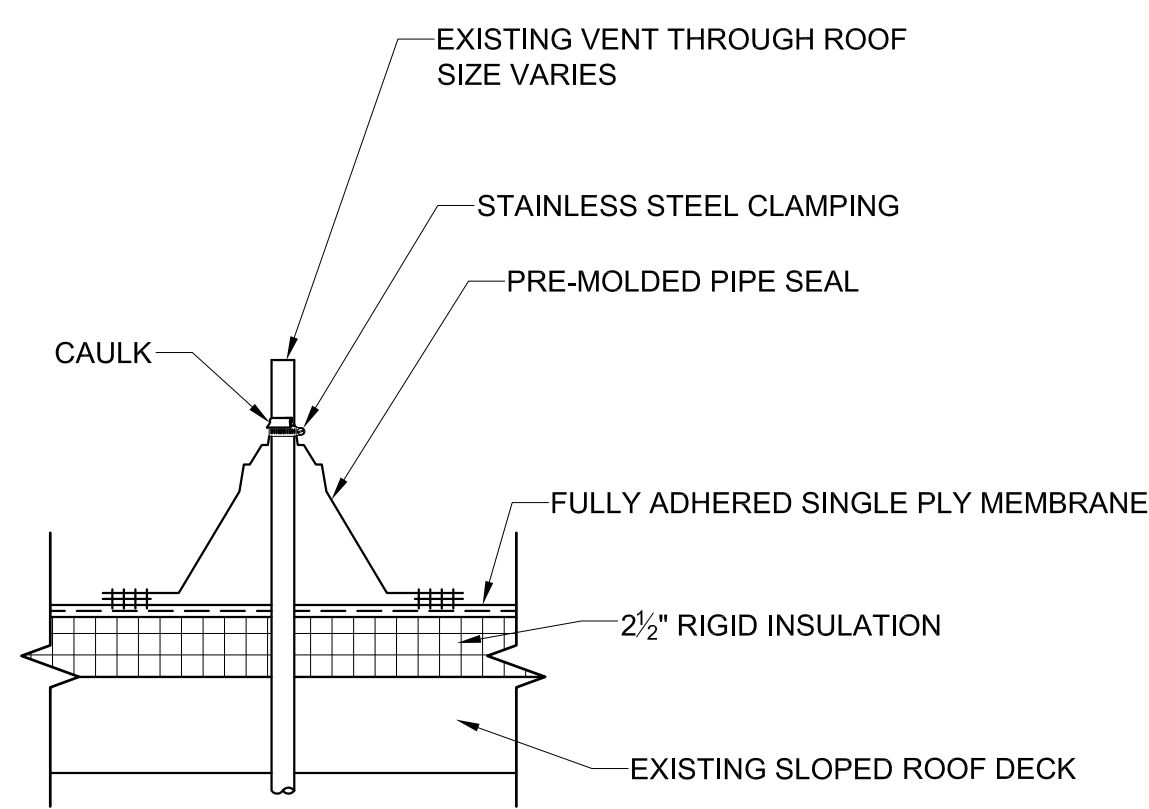

5 VTR DETAILS  
SCALE: 1/2" = 1'-0"

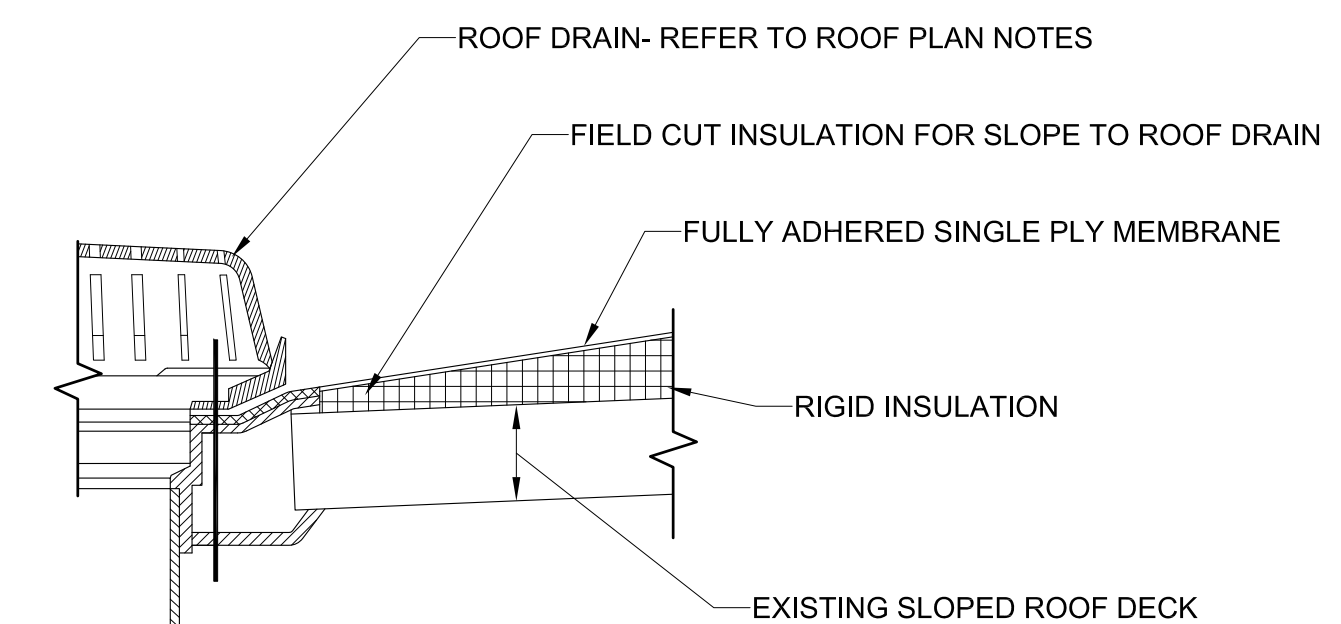

6 ROOF DRAIN DETAIL  
SCALE: 1/2" = 1'-0"

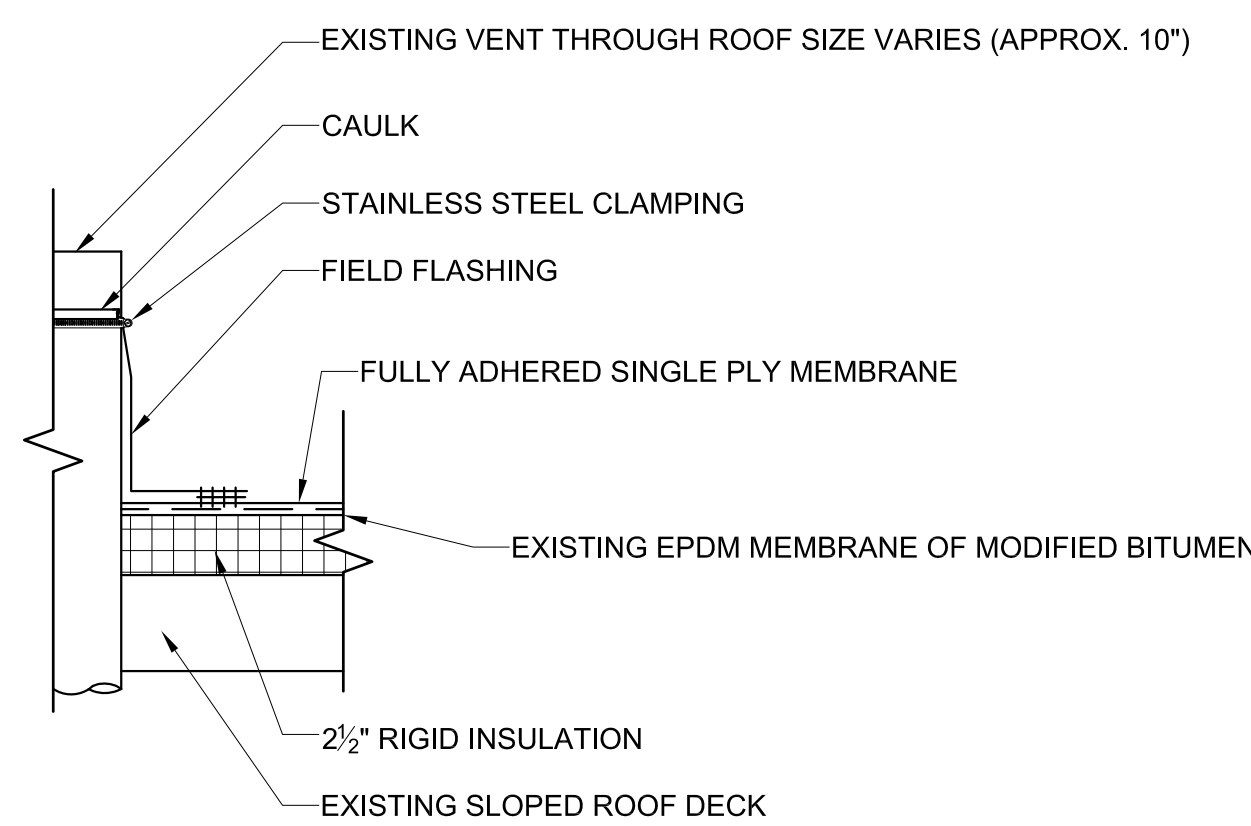

7 ROUND PIPE DETAIL  
SCALE: 1/2" = 1'-0"

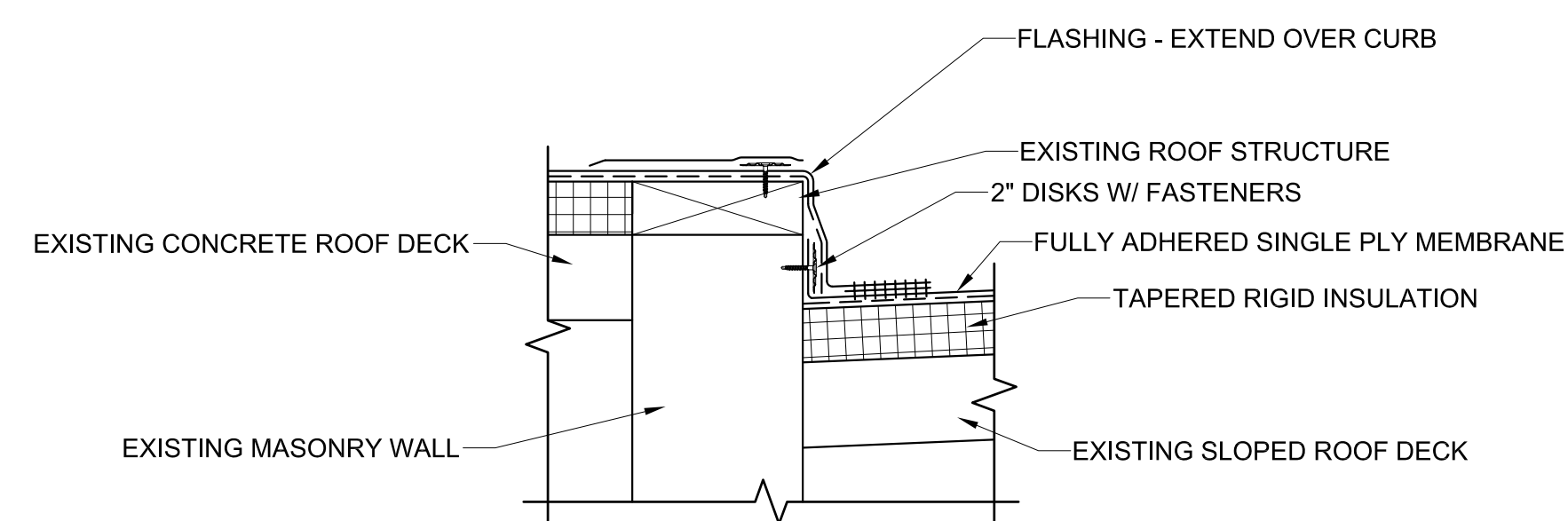

8 CURB DETAIL  
SCALE: 1/2" = 1'-0"

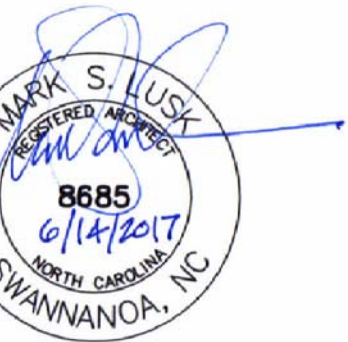

**HENDERSONVILLE  
HIGH SCHOOL  
STILLWELL  
BUILDING ROOF  
REPLACEMENT**

Project Number: 17007

Checked: \_\_\_\_\_

Drawn: A. Rognas

Date: 6/14/17

Revisions: \_\_\_\_\_

\_\_\_\_\_

\_\_\_\_\_

\_\_\_\_\_

\_\_\_\_\_

\_\_\_\_\_

\_\_\_\_\_

\_\_\_\_\_

\_\_\_\_\_

\_\_\_\_\_

\_\_\_\_\_

\_\_\_\_\_

\_\_\_\_\_

\_\_\_\_\_

\_\_\_\_\_

\_\_\_\_\_

\_\_\_\_\_

\_\_\_\_\_

\_\_\_\_\_

\_\_\_\_\_

\_\_\_\_\_

\_\_\_\_\_

\_\_\_\_\_

\_\_\_\_\_

**Details**

**A301**