

Henderson County, NC Residential Summary Sheet

This Box For Inspection Department Use Only				
Received	Rejected	Approved	Type Construction	Occupancy

General Contractor's Name: _____

General Contractors Phone #: _____

General Contractors license # and his or hers Signature _____

Assigned Property Address: _____

What are you building? _____

Directions from 100 N King St

Check all that apply:	Fill in <u>all</u> blanks:
<input type="checkbox"/> 1 Story <input type="checkbox"/> Basement <input type="checkbox"/> 1-1/2 or 2 Story <input type="checkbox"/> Crawl Space <input type="checkbox"/> 3 Story <input type="checkbox"/> Attached Garage	Heated Sq Ft: _____ Project Cost: _____ # Bedrooms: _____ Altitude of project (feet) _____ # Bathrooms: _____ Height: _____ Dimensions: _____ x _____

YES NO All walls are greater than 3 feet to a property line. (Walls within 3 feet of a property line must be one hour protected on both sides).

Type of Construction Check one (if applicable)

Frame on slab or foundation wall (crawl space or basement)

Frame & brick veneer on slab or foundation wall (crawl space or basement)

Monolithic slab

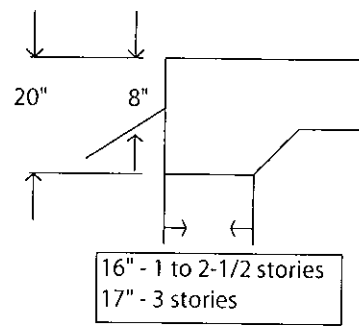
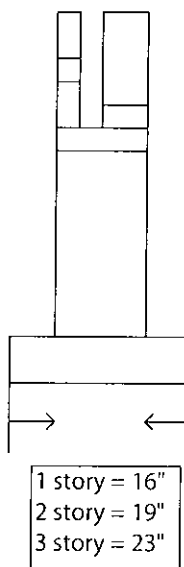
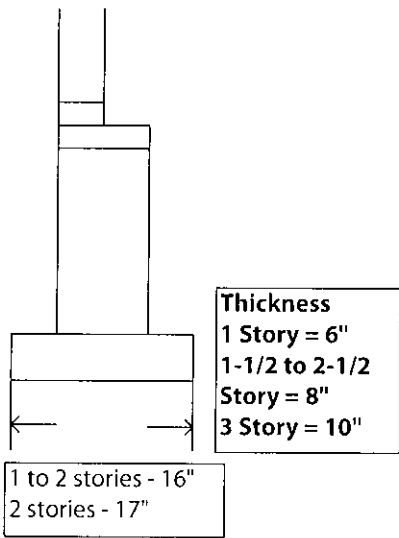

Other: Consult with the Building Official

Permit # _____

Check the applicable boxes:

Interior Piers: None: Yes → Tributary Area: _____ or → Continuous interior bearing wall

Check appropriate box

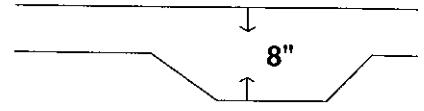

1 Story

1-1/2 or 2 Story

3 Story

Area	Pier	Footing
100	8 x 16	1-4 x 2-0 x 8"
150	8 x 16	2-0 x 2-0 x 8"
200	8 x 16	2-4 x 2-4 x 10"

Area	Pier	Footing
50	8 x 16	1-4 x 2-6 x 8"
100	8 x 16	2-0 x 2-6 x 10"
150	16 x 16	2-8 x 2-8 x 10"
200	16 x 16	3-0 x 3-0 x 10"
250	16 x 16	3-4 x 3-4 x 12"
300	16 x 16	3-8 x 3-8 x 12"

Area	Pier	Footing
50	8 x 16	1-4 x 2-6 x 8"
100	16 x 16	2-6 x 2-6 x 10"
150	16 x 16	3-0 x 3-0 x 10"
200	16 x 16	3-11 x 3-8 x 12"
250	16 x 24	4-0 x 4-0 x 12"
300	16 x 24	4-6 x 4-6 x 12"

Soil Classification

Table 401.4.1

Check one: *

GW, GP SW, SP	GM, GC, SM SM-SC, ML	SC, MH, ML-CL
<input type="checkbox"/>	<input type="checkbox"/>	<input type="checkbox"/>

(a) When soil tests are required by Section R401.4, the allowable bearing capacities of the soil shall be part of the recommendations.
 (b) Where the building official determines that in-place soils with an allowable bearing capacity of less than 2,000 psf are likely to be present at the allowable bearing capacity shall be determined by a soils investigation (engineered)

CLASS OF MATERIAL	LOAD-BEARING PRESSURE (pounds per square foot) (a)
Crystalline bedrock	12,000
Sedimentary and foliated rock	6,000
Sandy gravel and/or gravel (GW and GP)	5,000
Sand, silty sand, clayey sand, silty gravel and clayey gravel (SW, SP, SM, SC, GM and GC)	3,000
Clay, sandy clay, silty clay, clayey silt and sandy silt (CI, ML, MH and CH)	2,000 (b)

For SI: 1 pound per square foot = 0.0479 kN/m²

Foundation Walls

Height of wall (feet)	Unbalanced Fill (feet)
<input type="text"/>	<input type="text"/>

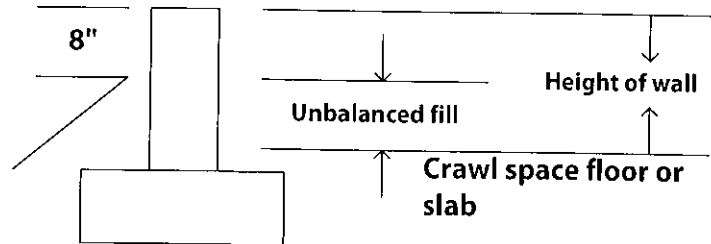

FOUNDATION WALL DETAILS ---- Check the appropriate boxes:

Print Form

Thickness of wall	Table 404.1.1(1)		Steel Reinforced concrete or block wall *	
	Concrete wall	Block wall		
		Hollow		Block Wall
6"	<input type="checkbox"/>	<input type="checkbox"/>	N/A	
8"	<input type="checkbox"/>	<input type="checkbox"/>	Table 404.1.1(2)	
10"	<input type="checkbox"/>	<input type="checkbox"/>	Table 404.1.1(3)	
12"	<input type="checkbox"/>	<input type="checkbox"/>	Table 404.1.1(4)	

* Fill in applicable box for steel reinforcing

Reinforcing Steel	Distance apart
#4	@ _____ inches o.c.
#5	@ _____ inches o.c.
#6	@ _____ inches o.c.
#7	@ _____ inches o.c.

Henderson County Building Permit Application

Property Owner: _____ Phone # _____

Applicant (If not owner) _____ Phone # _____

Job Site Address: _____

Sub Division: _____ Lot#: _____

Type of Work: New Addition Remodel Garage

Residential Addition/Remodel

If New:

Single Family Modular Townhouse

Duplex Condo/Apartment Other

Is there an attached garage? Yes No

Power Company: Duke Energy Progress Energy

Water Source: Well HVL City Asheville Community

Sewer: Septic Tank HVL City Cane Creek Community

Cost of Project: _____ Heated Square Footage: _____

Exterior: _____ # of Stories _____ # Bedrooms _____ # Bathrooms _____

Unfinished Basement Finished Basement

Crawl Space Slab

Heat Source: Heat pump Natural Gas LP Gas Oil Other _____

General Contractor: _____ License#: _____

Electrical Contractor: _____ License #: _____

HVAC Contractor: _____ License#: _____

Plumbing Contractor: _____ License#: _____