



HENDERSON COUNTY SITE PLAN FORM

A Henderson County site plan form is required as part of the building permit application to assign a property address to a proposed structure, determine county zoning requirements, and to apply for a well or wastewater/septic permit. An evaluation by Environmental Health cannot be scheduled nor can an address be assigned until this site plan form is completed per the following instructions.

Instructions: Please use the back of this form to draw the proposed structure for which a building permit is being requested and include all applicable items in the check list provided below. The applicant/property owner must sign and date the site plan form.

The following items shall be identified on this site plan:

- Dimensions of the property lines and orientation to streets, roads and driveways. (Include a north arrow.)
- Location of the proposed structure, including: decks, walkways, garages, pools or other structures. (Indicate the dimensions for all structures or show the dimensions of the maximum area you anticipate the structure will cover.)
- Location of all driveways. (Indicate driveway to be used for primary access for addressing purposes. If this is not included an address will not be assigned for the new structure.)
- Location of the preferred site for the wastewater/septic system including dimensions and setbacks.
- Existing and proposed wells. (Include wells located on adjacent properties, if known.)
- Location of all surface waters including springs, creeks, ponds, rivers, streams, wetlands, etc.
- Existing or proposed easements, encroachment agreements or right-of-way on the property. (This includes: access easements, utility easements, roads, or electrical right-of-way).
- For well applicants. Include location of existing or proposed chemical or petroleum storage tanks above or below ground.

COMPLETED SITE PLAN FROM EXAMPLE

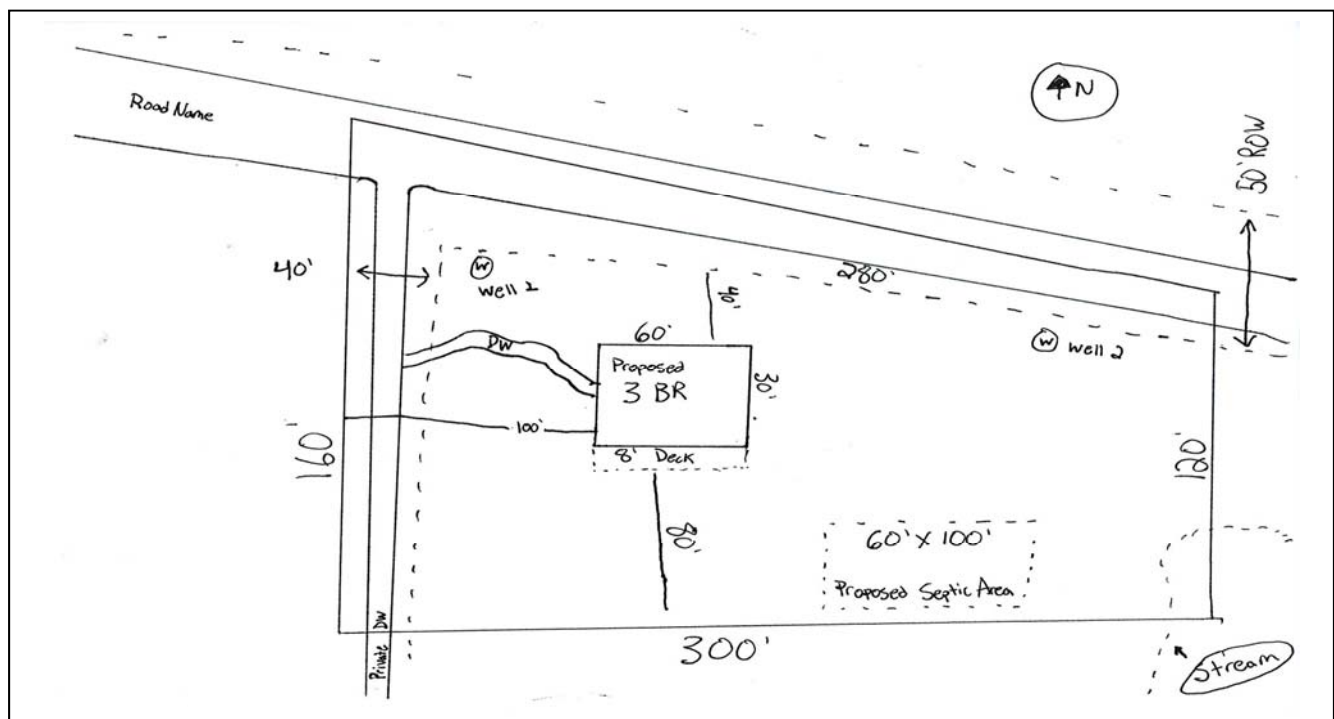

Site Plan Not Shown to Scale

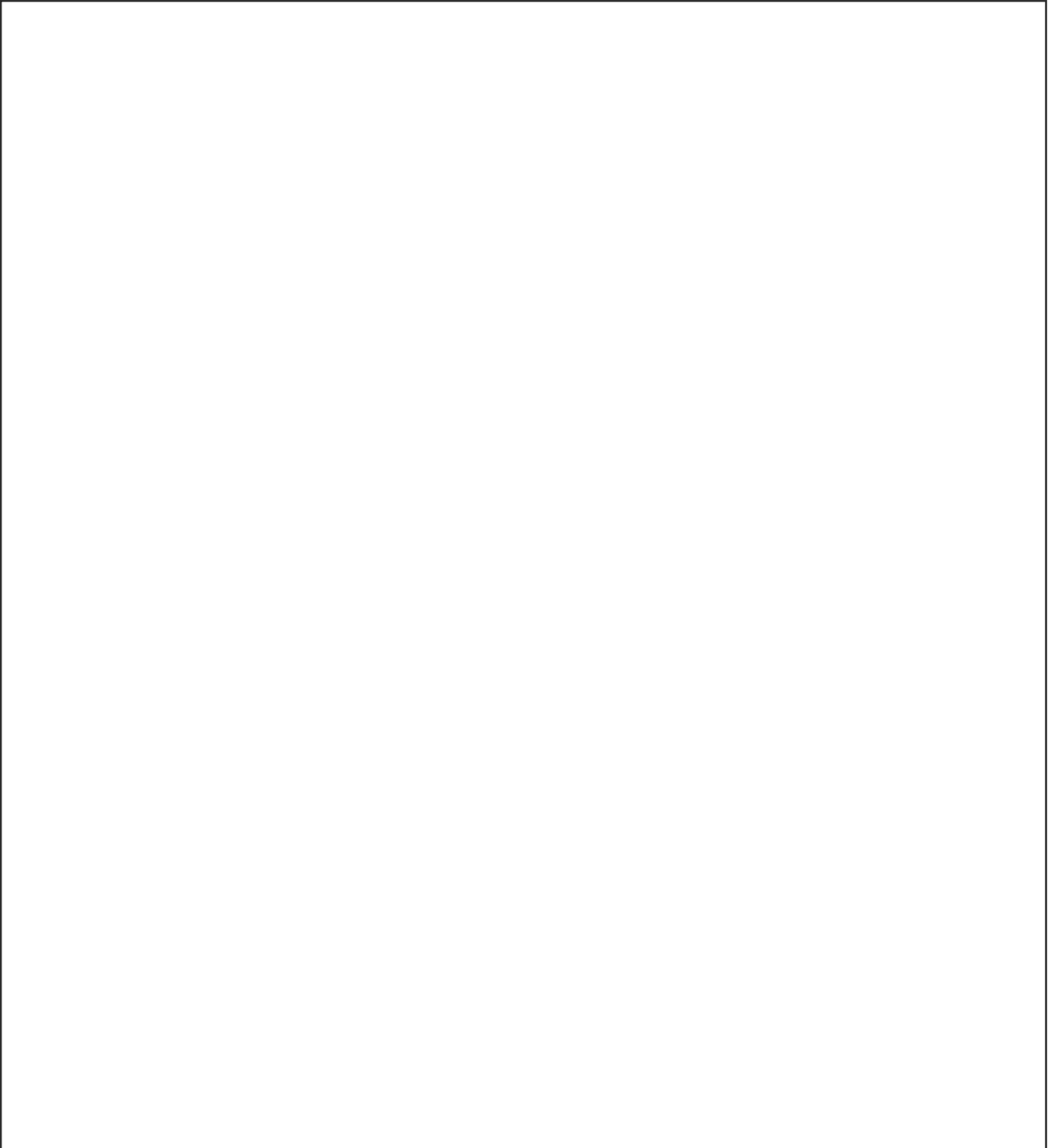

I hereby agree that the information shown is correct to the best of my knowledge. I understand that any changes to the property lines, building orientation, or location of driveways may void this site plan and require a new site evaluation by environmental health or result in a change to the property address.

Signature of Authorized Agent/Owner

Date